

Butler Land Company

Henning Road Farm

County: Vermilion
 State: Illinois
 Twp: Blount (N)
 Property type: Tillable

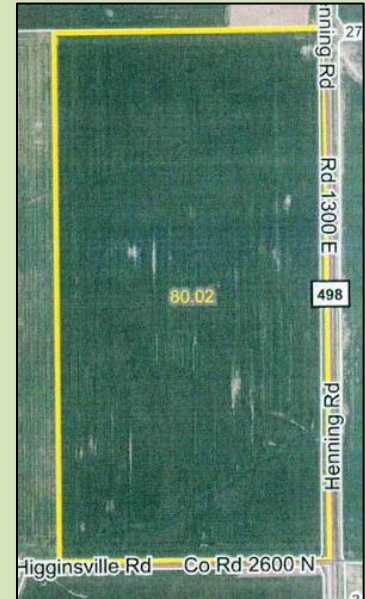

Directions: 3½ miles south of Henning, Illinois or approximately 3 miles north of Kennekuk County Park on west side of Henning Road.

- 82.283 surveyed total acres, 78.618 tillable acres
- Great investment property
- **If farm is purchased by investor, prior farm tenant would be available to continue farming the land.**
- Primary soils: Elliott Silt loam, Ashkum Silty Clay loam
- Productivity Index: 125.8
- Possession available for 2020
- Henning Road (two-lane highway) on east side, Higginsville Road on south side. Both hard-surfaced roads.
- Real Estate Taxes: On two separate tax bills with additional acreage. Part is taxed at \$25..28/acre and part at \$28.38 per acre.
- Survey and 156EZ Farm Record available upon request.

Price - \$8,200 per acre

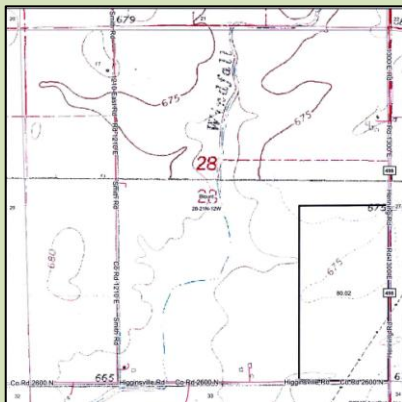

Frank Butler
 Illinois Managing Broker • Indiana Principal Broker • Farm Manager
Butler Land Company
 515 Poland Road, Danville, IL 61834
 217-260-4742
www.butlerlandco.com

Area Symbol: IL183, Soil Area Version: 15

Code	Soil Description	Acres	Percent of field	Il. State Productivity Index Legend	Subsoil rooting <i>a</i>	Corn Bu/A	Soybeans Bu/A	Wheat Bu/A	Oats Bu/A <i>b</i>	Sorghum c Bu/A	Alfalfa d hay, T/A	Grass-legume e hay, T/A	Crop productivity index for optimum management
146A	Elliott silt loam, 0 to 2 percent slopes	46.42	58.0%		FAV	168	55	68	87	0	0.00	5.02	125
232A	Ashkum silty clay loam, 0 to 2 percent slopes	33.60	42.0%		FAV	170	56	65	85	0	0.00	5.14	127
Weighted Average						168.8	55.4	66.7	86.2	*-	0.00	5.07	125.8

